



alpine-property

Alpine Property SAS au capital de 3 450 € - RCS Thonon les Bains 508 578 556 - siège: 153 chemin du Chargeau, 74110 Morzine, France - Titulaire de la Carte Professionnelle n° CPI 7401 2016 000 017 391 délivrée par la CCI de la Haute Savoie

Tel: +44 (0)208 123 2384

Email: info@alpine-property.com

Web: www.alpine-property.com

Appt. Le Relais

Saint Jean d'Aulps, St Jean d'Aulps & Vallée, Portes Du Soleil

123 000 €uros



Contact

Contact **Angélique Courbot** about this property.

Tel: 06 12 23 51 64

Email: angelique@alpine-property.com

Key Features

Price	123 000 €uros
Status	FOR SALE
Last updated	29/04/2026
Area	Portes Du Soleil
Location	St Jean d'Aulps & Vallée
Village	Saint Jean d'Aulps
Bathrooms	1
Floor area	27.8 m ²
Heating	Electric radiators
Nearest skiing	100 m
Nearest shops	50 m
Drainage	Mains drains
Taxe foncière	341.00 €uros
Annual charges	1500.00 €uros
Number of lots	73
Procédure en cours	No
Energy efficiency rating	F (426)
CO2 emissions	C (15)
Agency fees	Paid by the seller

Property Description

Spacious 27.81 m² studio located on the 2nd floor of a residence close to the Roc d'Enfer télécabine. The property features a large entrance area with a 'coin montagne' (bunk -beds) , a well-designed open-plan living room and kitchen, and a large bay window opening onto a south-facing private balcony.

There is also a bathroom with a bath, washbasin, and WC. The sleeping area is currently arranged to accommodate up to 4 people.

Additional information / Location

All resort amenities are within walking distance, including bars, restaurants, grocery shops, and ski rental stores, providing everything needed for a comfortable stay.

The Saint-Jean-d'Aulps ski resort is small and friendly, offering a lively atmosphere and excellent slopes around the stunning Roc d'Enfer. A weekly market and regular events throughout the winter season add to the charm and energy of the resort.

The larger resort of Morzine is less than 10 minutes by car and is also accessible by ski bus, giving access to the entire Portes du Soleil ski area.

The property is covered by the copropriété rules.











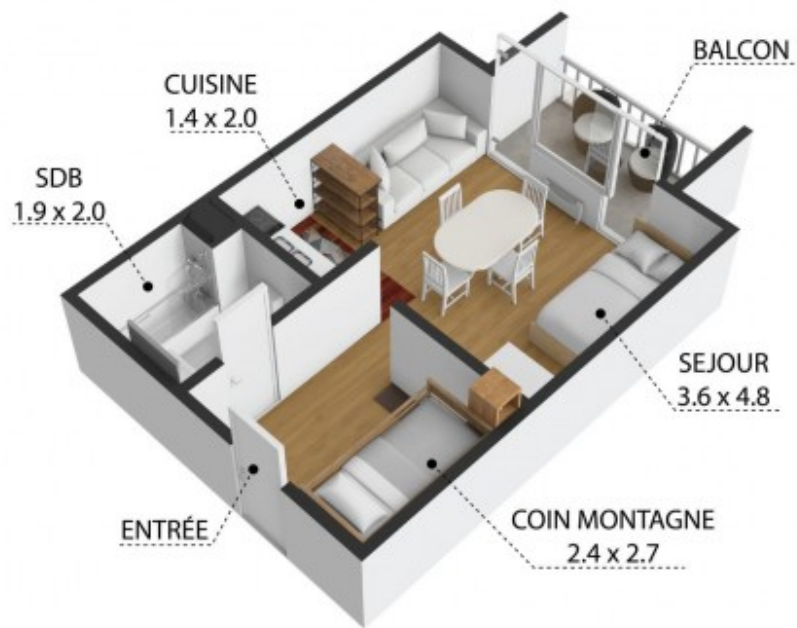

Toutes les dimensions indiquées sont approximatives.
 The plans shown are approximate and for information purposes only.

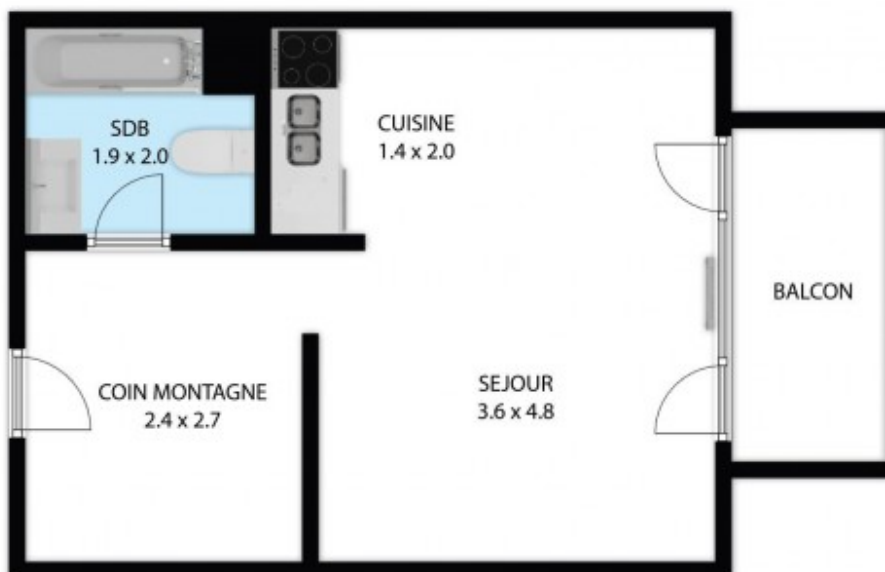

Toutes les dimensions indiquées sont approximatives.
 The plans shown are approximate and for information purposes only.

