



**alpine-property**

Alpine Property SAS au capital de 3 450 € - RCS Thonon les Bains 508 578 556 - siège: 153 chemin du Chargeau, 74110 Morzine, France - Titulaire de la Carte Professionnelle n° CPI 7401 2016 000 017 391 délivrée par la CCI de la Haute Savoie

Tel: +44 (0)208 123 2384

Email: [info@alpine-property.com](mailto:info@alpine-property.com)

Web: [www.alpine-property.com](http://www.alpine-property.com)

# Appt. A22, Les Balcons de la Bechigne

**Chatel, Châtel & Vallée, Portes Du Soleil**

**798 000 €uros**



## Contact

Contact **Ed Ockelton** about this property.

**Tel:** +33 6 77 83 19 98

**Email:** [ed@alpine-property.com](mailto:ed@alpine-property.com)

# Key Features

<b>Price</b>	798 000 Euros
<b>Status</b>	FOR SALE
<b>Last updated</b>	02/05/2026
<b>Area</b>	Portes Du Soleil
<b>Location</b>	Châtel & Vallée
<b>Village</b>	Chatel
<b>Bedrooms</b>	3
<b>Bathrooms</b>	3
<b>Floor area</b>	94.8 m <sup>2</sup>
<b>Heating</b>	Underfloor heating
<b>Nearest skiing</b>	800 m
<b>Nearest shops</b>	500 m
<b>Garage</b>	Single
<b>Drainage</b>	Mains drains
<b>Number of lots</b>	5
<b>Procédure en cours</b>	No
<b>Energy efficiency rating</b>	TBC
<b>CO2 emissions</b>	TBC
<b>Agency fees</b>	Paid by the seller

## Property Description

Les Balcons de la Bechigne is a project of 5 high quality apartments located on the Route du Bechigne, not far from the centre of Chatel.

With only 5 apartments in the building, this development offers chalet style living with the convenience of a lock up and leave apartment.

The apartments will all adhere to the latest norms for energy efficiency offering individual gas central underfloor heating systems and on demand hot water.

Apartment A22 (04), on the second floor, is a three bedroom property with extra coin montagne sleeping area. It benefits from 94.75 sq m of habitable space, a balcony of 23 sq m, a garage and ski locker. The total price (including garage and kitchen) is 798.800 €.

The building is located on the Route du Bechigne with excellent views, and only a short walk to the centre of Chatel.

Delivery is planned for the end of the 3rd quarter, 2027.

[Appt. A11, 2 bedrooms, 2 bathrooms, plus bunk sleeping area - 599,800€](#)

[Appt. A12, 3 bedrooms, 3 bathrooms, plus bunk sleeping area - 784,600€](#)

[Appt. A21, 2 bedrooms, 2 bathrooms, plus bunk sleeping area - 619,000€](#)

[Appt. A31, 5 bedrooms, 4 bathrooms - 1,520,000€](#)

The property is covered by the copropriété rules.





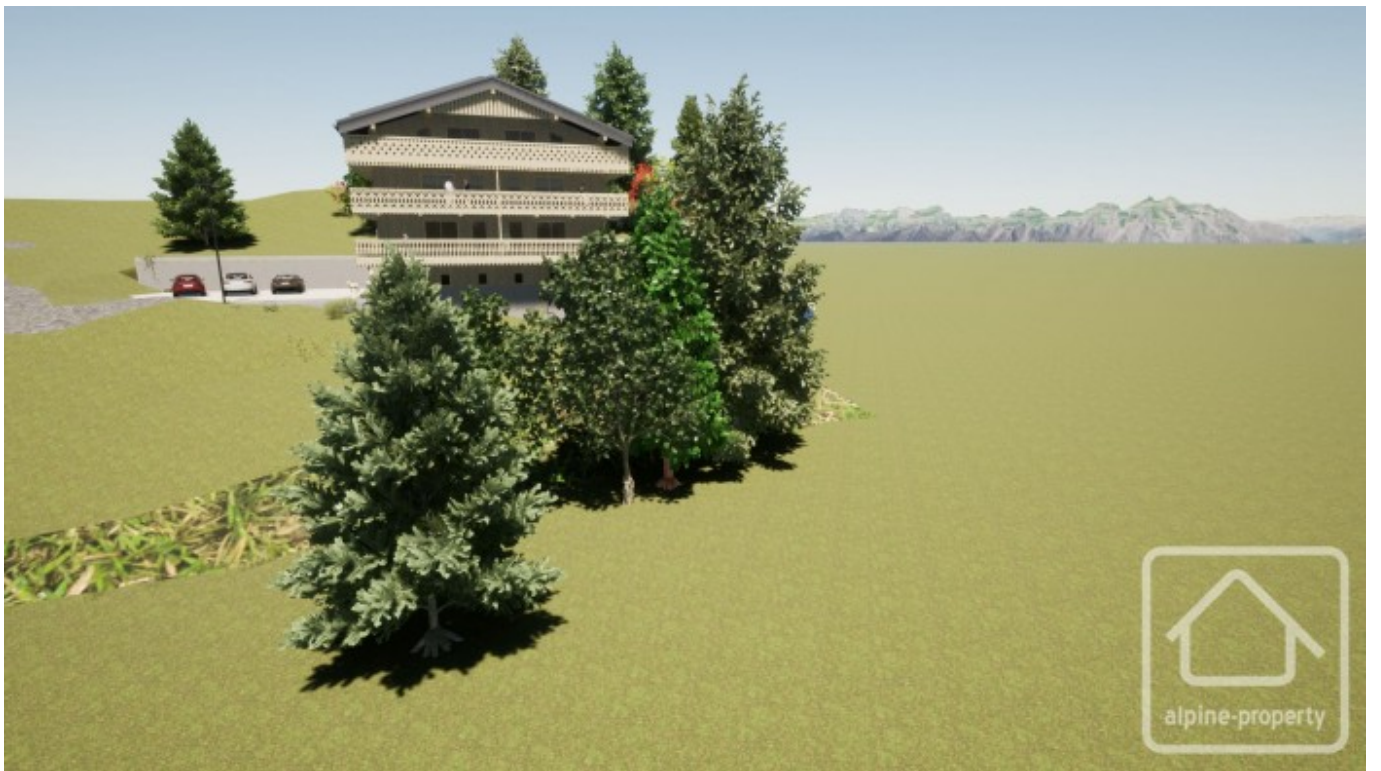



LES BALCONS DE LA BECHIGNE



NIVEAU	TYPE	LOGEMENT
R+2	T4 BIS	04



FABIENNE GROS ARCHITECTE

HALL / DGT	13.40m <sup>2</sup>
SEJOUR / CUISINE	30.15m <sup>2</sup>
CHAMBRE1 + SDB	19.20m <sup>2</sup>
CHAMBRE2 + SDB	14.70m <sup>2</sup>
CHAMBRE3	11.20m <sup>2</sup>
COUCHETTE	2.90m <sup>2</sup>
SEB	4.00m <sup>2</sup>
WC	2.15m <sup>2</sup>
<hr/>	
<hr/>	
<hr/>	
<hr/>	
<hr/>	
<hr/>	
<b>TOTAL SL / FAC<sup>2</sup> HABITABLE :</b>	<b>94.75</b>
BALCON	23.20m <sup>2</sup>

DATE : 31/03/2012

Les éléments d'ouvrage sont donnés à titre indicatif (voir page, etc.). Les cotés, les surfaces ainsi que les positions des éléments techniques sont donnés pour donner une idée globale de construction et des balances d'équilibre.

NOTA : les surfaces de plus sont comprises dans les surfaces de plan.



PLAN T4 BIS



M.L. bois