



alpine-property

Alpine Property SAS au capital de 3 450 € - RCS Thonon les Bains 508 578 556 - siège: 153 chemin du Chargeau, 74110 Morzine, France - Titulaire de la Carte Professionnelle n° CPI 7401 2016 000 017 391 délivrée par la CCI de la Haute Savoie

Tel: +44 (0)208 123 2384

Email: info@alpine-property.com

Web: www.alpine-property.com

Chalet Alouette

Servoz, Chamonix & Vallée, Mont Blanc

850 000 €uros



Contact

Contact **Claire Williams** about this property.

Tel: +33 6 23 49 38 20

Email: claire@alpine-property.com

Key Features

Price	850 000 Euros
Status	FOR SALE
Last updated	17/06/2025
Area	Mont Blanc
Location	Chamonix & Vallée
Village	Servoz
Bedrooms	4
Bathrooms	4
Floor area	146.8 m²
Land area	972 m²
Detached	Yes
Heating	Oil fired central heating
Chimney	Enclosed fire
Nearest skiing	5.7 km
Nearest shops	900 m
Garden	Yes
Garage	Double
Drainage	Mains drains
Energy efficiency rating	E (285)
CO2 emissions	E (61)
Agency fees	Paid by the seller

Property Description

Chalet Alouette is a charming four bedroom chalet in the picturesque village of Servoz, in the heart of the Chamonix Valley. Set on a flat and sunny 972 m² plot, the property offers 146.8 m² of habitable space with a total area of 226 m². Surrounded by breathtaking views of the Mont Blanc massif and offering excellent potential for renovation or extension, it is the perfect choice for those looking to create a bespoke mountain retreat in an authentic setting.

The chalet comprises thus:

Garden level: Two spacious garages totalling 79.4 m² (one of which includes windows and could be converted into a self-contained studio apartment subject to planning permission), cellar, laundry/technical room, separate WC.

First floor: Entrance hall, two bedrooms (one with an en-suite bathroom), a separate WC, a bright and airy living room with an open fireplace and direct access to a balcony with stunning mountain view, a kitchen completes this level, offering scope for modernisation or an open-plan conversion to suit modern living preferences.

Top floor: Two double bedrooms, each with their own private en-suite bathroom, separate WC, storage space in the eaves.

The chalet retains much of its original charm and character and is in very good condition overall, though it would benefit from internal updates to reach its full potential.

Servoz itself is a highly sought-after area, known for its natural beauty, strong community feel, and proximity to ski resorts, hiking trails, and year-round outdoor activities.

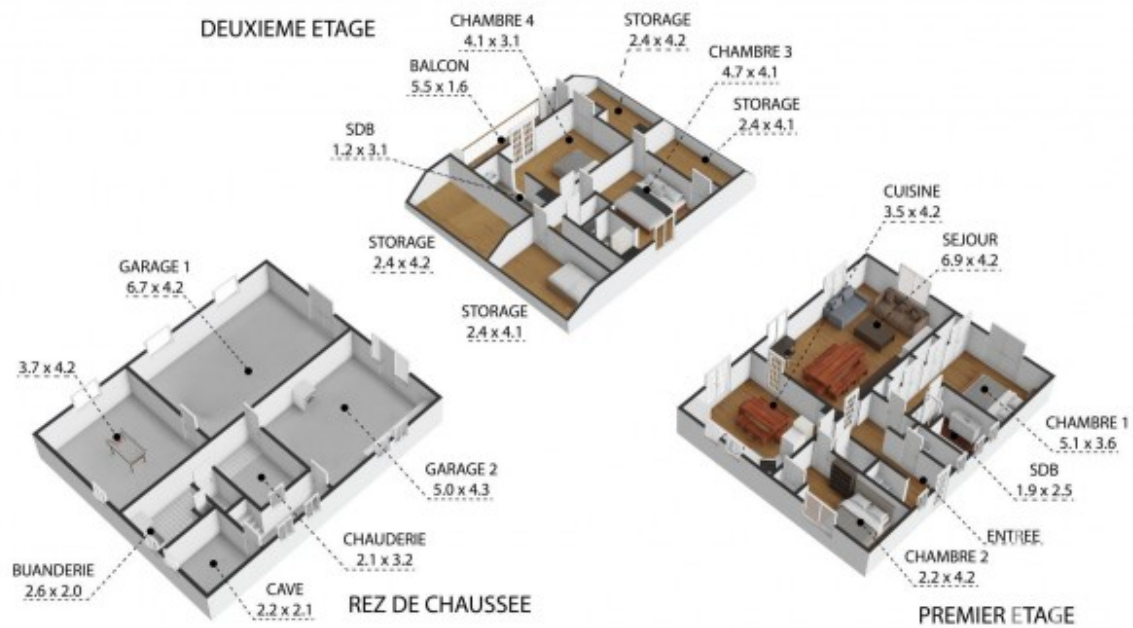

Toutes les dimensions indiquées sont approximatives.
The plans shown are approximate and for information purposes only.



Toutes les dimensions indiquées sont approximatives.
The plans shown are approximate and for information purposes only.









