



**alpine-property**

Alpine Property SAS au capital de 3 450 € - RCS Thonon les Bains 508 578 556 - siège: 153 chemin du Chargeau, 74110 Morzine, France - Titulaire de la Carte Professionnelle n° CPI 7401 2016 000 017 391 délivrée par la CCI de la Haute Savoie

Tel: +44 (0)208 123 2384

Email: [info@alpine-property.com](mailto:info@alpine-property.com)

Web: [www.alpine-property.com](http://www.alpine-property.com)

# La Ferme du Risse

**Mégevette, Vallée Du Risse, Alpes du Léman**

**190 000 €uros**



## Contact

Contact **Anna Allen** about this property.

**Tel:** +33 6 12 79 07 63

**Email:** [anna@alpine-property.com](mailto:anna@alpine-property.com)

# Key Features

<b>Price</b>	190 000 €uros
<b>Status</b>	SOLD
<b>Last updated</b>	13/02/2019
<b>Area</b>	Alpes du Léman
<b>Location</b>	Vallée Du Risse
<b>Village</b>	Mégevette
<b>Bedrooms</b>	1
<b>Floor area</b>	200 m <sup>2</sup>
<b>Land area</b>	1600 m <sup>2</sup>
<b>Detached</b>	Yes
<b>Chimney</b>	Wood burning stove
<b>Nearest skiing</b>	7 km
<b>Nearest shops</b>	3 km
<b>Garden</b>	Yes
<b>Drainage</b>	Mains drains
<b>Agency fees</b>	Paid by the seller

## Property Description

There is plenty of potential for this fabulous property, a conventional Savoyard construction of the time where the family lived on the sunny side of the building, the livestock at the back with their own entrance and a large hayloft above. Situated on the outskirts of the village of Megevette, this spacious farm house has exceptional views of the surrounding nature and the mountains across the river valley.

On the ground floor there are 3 large rooms, a stable and cellar. The barn is huge with 190m<sup>2</sup> floor area and over 7m to the apex. Plenty of space for a mezzanine and large windows to capitalise on the view. There is 1600m<sup>2</sup> of gently sloping land and this includes a two story mazot with a vaulted cellar beneath.

Water and electricity are close by, as are the mains drains.

There are numerous walks in the area and a cross country ski piste in the village. For the ski resorts it is 10mins drive to Hirmentaz, 20mins to Sommand, and 45mins to the Portes du Soleil, Flaine and Geneva airport.

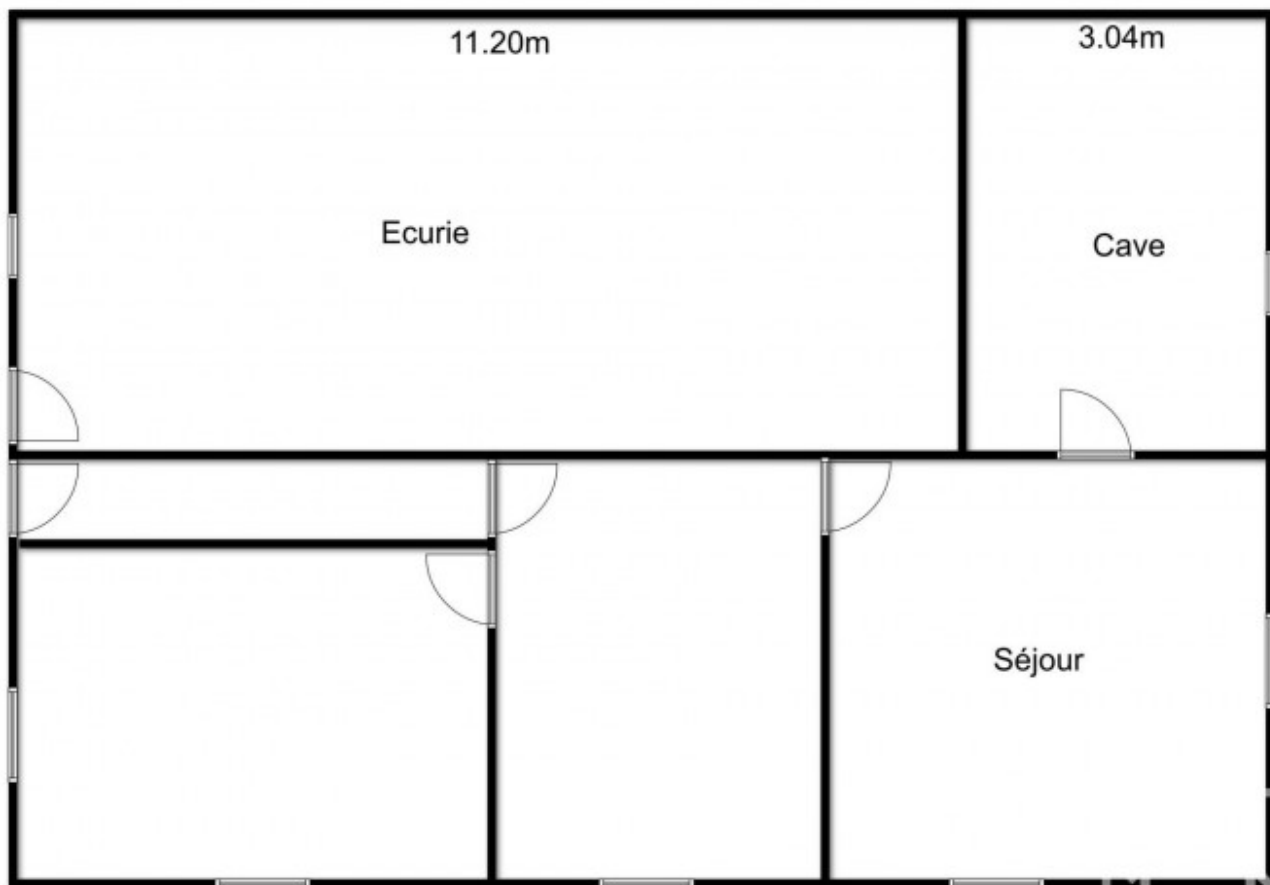

RDC

