



alpine-property

Alpine Property SAS au capital de 3 450 € - RCS Thonon les Bains 508 578 556 - siège: 153 chemin du Chargeau, 74110 Morzine, France - Titulaire de la Carte Professionnelle n° CPI 7401 2016 000 017 391 délivrée par la CCI de la Haute Savoie

Tel: +44 (0)208 123 2384

Email: info@alpine-property.com

Web: www.alpine-property.com

Appt. Flocon

Vallorcine, Chamonix & Vallée, Mont Blanc

205 000 €uros



Contact

Contact **Manu Maclean** about this property.

Tel: +33 6 02 50 75 03

Email: manu@alpine-property.com

Key Features

Price	205 000 Euros
Status	UNDER CONTRACT
Last updated	06/05/2024
Area	Mont Blanc
Location	Chamonix & Vallée
Village	Vallorcine
Bedrooms	1
Bathrooms	1
Floor area	37.2 m²
Heating	Combined system
Nearest skiing	100 m
Nearest shops	6.5 km
Garage	Single
Drainage	Mains drains
Annual charges	2800.00 Euros
Number of lots	195
Procédure en cours	No
Energy efficiency rating	C (158)
CO2 emissions	A (4)
Agency fees	Paid by the seller

Property Description

Apartment Flocon is in the delightful 4* holiday complex of the Portes de Mont Blanc in Vallorcine. Situated right next to the Vallorcine cable-car, it offers a direct access to the slopes and fantastic mountain views. And if you don't feel like heading up the mountain, you can enjoy the on-site facilities - heated pool with views on to the cable-car, wellness and spa area, childrens' play areas and excellent restaurant with large sunny terrace. It offers a truly perfect escape.

The Mont Blanc Express railway stop is 100m from the apartment, providing easy and environmentally friendly access to Chamonix town and the whole of the valley.

The apartment is located on the ground floor and is configured thus:

Entrance leading into open-plan kitchen/dining room/living room (19,5m²) with patio doors onto large terrace of 15,4m². Double bedroom with private access to terrace and ensuite bathroom.

Decor and interior finish are in excellent condition.

This apartment is sold freehold with no restrictions and comes with a private underground parking space and ski locker.

The property is covered by the copropriété rules.











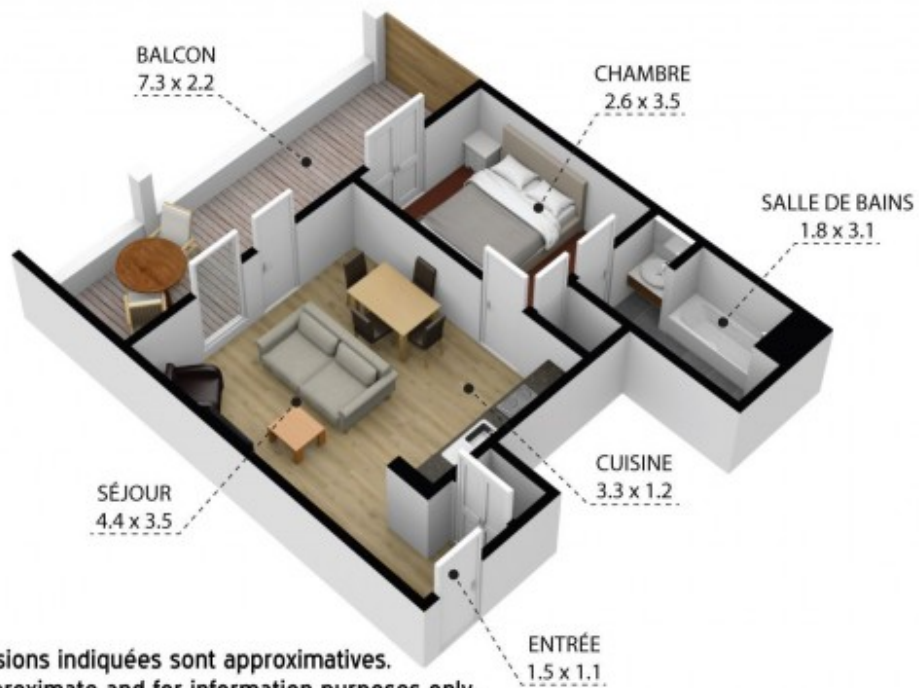

Toutes les dimensions indiquées sont approximatives.
The plans shown are approximate and for information purposes only.



Toutes les dimensions indiquées sont approximatives.
The plans shown are approximate and for information purposes only.



